

PERMIT

CITY OF NAPOLEON, OHIO — DEPT. OF BUILDING & ZONING
255 W. Riverview Avenue, Napoleon, Ohio 43545 (419) 592-4010

0932

Permit No. 0932 Date Oct. 26, 1984
Job Location 1472 Taylor Drive Valuation \$ 8250.00
Owner Ronald Bostelman Address 1472 Taylor Dr.
Contractor Ron Zachrich Builders Telephone No. 762-5277
Address Rt. 2 Napoleon
Electric Contractor Ron Zachrich
Plumbing Contractor
Mechanical Contractor

This permit is issued for work described in the plans, specifications, and/or application submitted, as approved by the Building Commissioner of the City of Napoleon, Ohio. Work shall conform to all pertinent construction and land use Codes and Ordinances.

Work Information:

Residential Single Commercial Industrial
New Construction Addition X Remodel
Brief Description of Work 15 1/2 ft. X 24 ft. Sun Room

ISSUED BY Richard J. ... DEPT. OF BUILDING & ZONING PAID

It is the owners or contractors responsibility to call the Building Department for the following (X) inspections:

- X Footing excavation prior to placing concrete.
X Footing drains and foundation prior to backfill.
Prepared sub-grade prior to placing concrete floor slab.
Sanitary sewer
X Rough-in electrical, plumbing and service framing prior to installing wall board.
X Final electrical, plumbing and heating.
X Final building inspection, prior to occupancy.

Table with 2 columns: Permit Type, Fee Amount. Includes Building Permit (\$22.50), Electrical Permit (\$6.00), Plumbing Permit, Mechanical Permit, Demolition Permit, Zoning Permit, Sign Permit, Water Tap, Sewer Tap, Temp. Elec., Other.

TOTAL FEES \$ 28.50
LESS FEES PAID \$ -0-
BALANCE DUE \$ 28.50

OCT 29 1984 CITY OF NAPOLEON

Permit is not valid until all fees are paid in full, and shall be void if work is not started within six months of date above.

PERMIT

CITY OF NAPOLEON, OHIO — DEPT. OF BUILDING & ZONING
255 W. Riverview Avenue, Napoleon, Ohio 43545 (419) 592-4010

Permit No. 0950 Date Oct. 25, 1984
 Job Location 1472 Taylor Drive Valuation \$ 0250.00
Address
 Owner Ronald Bostelman Address 1472 Taylor Dr.
Name
 Contractor Ron Zachrich Builders Telephone No. 762-5277
Address Rt. 2 Napoleon
 Electric Contractor Ron Zachrich
 Plumbing Contractor _____
 Mechanical Contractor _____

This permit is issued for work described in the plans, specifications, and/or application submitted, as approved by the Building Commissioner of the City of Napoleon, Ohio. Work shall conform to all pertinent construction and land use Codes and Ordinances.

Work Information:
 Residential Single Commercial _____ Industrial _____
No. dwelling units
 New Construction _____ Addition X Remodel _____
 Brief Description of Work 13 ft. X 24 ft. Sun Room

ISSUED BY _____ DEPT. OF BUILDING & ZONING
Building Official

PAID
OCT 29 1984
CITY OF NAPOLEON

It is the owners or contractors responsibility to call the Building Department for the following (X) inspections:

- Footing excavation prior to placing concrete.
- Footing drains and foundation prior to backfill.
- Prepared sub-grade prior to placing concrete floor slab.
- Sanitary sewer
- Rough-in electrical, plumbing and service framing prior to installing wall board.
- Final electrical, plumbing and heating.
- Final building inspection, prior to occupancy.

PERMIT & FEES	
Building Permit	\$ <u>22.50</u>
Electrical Permit	\$ <u>6.00</u>
Plumbing Permit	\$ _____
Mechanical Permit	\$ _____
Demolition Permit	\$ _____
Zoning Permit	\$ _____
Sign Permit	\$ _____
Water Tap	\$ _____
Sewer Tap	\$ _____
Temp. Elec.	\$ _____
Other	\$ _____
TOTAL FEES	\$ <u>28.50</u>
LESS FEES PAID	\$ <u>-0-</u>
BALANCE DUE	\$ <u>28.50</u>

Permit is not valid until all fees are paid in full, and shall be void if work is not started within six months of date above.

1/15/04 General cleanup

INSPECTION RECORD

UNDERGROUND			ROUGH-IN			FINAL		
Type	Date	By	Type	Date	By	Type	Date	By
PLUMBING	Sewer Connection		Drainage, W. & Vent			Drainage, W. & Vent		
	Building Sewer		Water Piping			Water Heater		
	Water Piping		Condensate Lines			Backflow Prevention		
			Indirect Waste					
ELECTRICAL	Floor Ducts Raceways		Rough Wiring			FINAL APPROVAL		
	Conduits & or Cable		Conduits/ Cable			Electric Mtr. Clearance		
	Grounding & Bonding		Service Panel Switchboard			Signs		
			Subpanels					
			<input type="checkbox"/> Range <input type="checkbox"/> Dryer			FINAL APPROVAL		
MECHANICAL	Refrigerant Piping		Refrigerant Piping			Duct Insulation		
	Ducts/ Plenums		Ducts/ Plenums			Chimney(s)		
			Ventilation <input type="checkbox"/> Supply			Furnace(s)		
			<input type="checkbox"/> Exhst.			FINAL APPROVAL		
BUILDING	Location, Set-backs, Esmt(s)		Wall Construction			Fireplace Chimney		
	Excavation		Crawl Space <input type="checkbox"/> Vent <input type="checkbox"/> Access			Attic <input type="checkbox"/> Vent <input type="checkbox"/> Access		
	Footings & Reinforcing		Floor System(s)			Special Insp Reports Rec'd		
	Sub-soil Drain		Roof System			Smoke Detector		
	Foundation Walls		Fire Wall(s)			Demolition (sewer cap)		
	Floor Slab		Roof Cover Roof Drain			Building or Structure		
FINAL APPROVAL BLDG. DEPT			Certificate of Occupancy Issued			#		

CITY OF NAPOLEON
BUILDING INSPECTION DEPARTMENT
APPLICATION FOR BUILDING PERMIT
(Please print or type)

The undersigned hereby makes application for construction, installation, or alteration work as herein specified, agreeing to do all such work in strict accordance with the City of Napoleon's adopted Building Codes.

Location of project 1472 Taylor Dr. Cost of project 8250.⁰⁰
Owner's Name Ronald Bostelman Address 1472 Taylor Dr
Contractor Ron Zachrich Bldr Telephone No. 762-5277
Address Rt. 2 Napoleon

Lot Information: (Not required for siding job)

Lot No. _____ Subdivision Taylor
Zoning District _____ Lot Size 115 ft. X 124 ft. Area 14260 sq. ft.
Setbacks: Front 50 Right Side 10 Left Side 25 Rear 23

Work Information:

Residential Commercial _____ Industrial _____
New Construction _____ Addition Remodel _____
Accessory Building _____ Siding _____
(Specific Type)

Brief Description of Work:----- New Sunroom

Size: Length 15-6 Width 24 No. of Stories 1
Area: *1st Floor _____ sq. ft. Basement _____ sq. ft.
2nd Floor _____ sq. ft. Accessory Bldg. _____ sq. ft.
3rd Floor _____ sq. ft. Other _____ sq. ft.

Additional Information: _____

APPLICATION FOR PERMIT, SHALL BE ACCOMPANIED BY TWO COMPLETE SETS OF PLANS INCLUDING: ELEVATIONS, FLOOR PLANS, CROSS SECTIONS AND PLOT PLAN. IF ADDITION OR REMODELING, SHOW ALL EXISTING STRUCTURES AND THEIR SIZE AND LOCATION. ALL PLANS SHALL BE DRAWN TO SCALE.

Date 10-26-84 Applicant's Signature Ron Zachrich

PERMIT NO. _____
PERMIT FEE \$ _____

CITY OF NAPOLEON
BUILDING INSPECTION DEPARTMENT
APPLICATION FOR ELECTRICAL PERMIT
(Please print or type)

The undersigned hereby makes application for installation or replacement of electrical equipment as herein specified, agreeing to do all such work in strict accordance with the City of Napoleon's adopted Electrical Codes.

Owner's Name Ronald Bestelman Address 1472 Taylor Dr

Electrical Contractor Ron Zachrich Telephone No. 762-5277

Address Rt. 2 Napoleon

General Contractor Ron Zachrich Telephone No. _____

Address _____

Location of Project 1472 Taylor Cost of Project 8250.⁰⁰

Work Information:

Residential Commercial _____ Industrial _____

No. Units _____

New _____ Service Change _____ Rewiring _____ Additional Wiring

Brief Description of Work: Ceiling Light, 5 receptacles

Size of proposed service entrance _____ Number of new circuits _____

Type of proposed service entrance _____ Underground _____ Overhead _____

Require Temporary Electric _____ (Yes or No)

Total Floor Area - Commercial and Industrial only _____ sq. ft.

Additional Information: _____

*Ground fault circuit interrupter protection is required on all 120-volt single phase, 15 and 20 amp. Circuits which are part of a temporary electric service; and also on bathroom, outdoor, and garage receptacles in all dwelling units. Art. 210-8 N.E.C.

*Application for permit shall be accompanied by two complete sets of plans including: Electrical layout and riser diagram. (For commercial and industrial work only).

Date 10-26-84

Applicant's Signature Ron Zachrich

PERMIT NO.

PERMIT FEE \$

VIII. ZONING PLAN EXAMINERS NOTES

DISTRICT *1472 Taylor Drive*

USE *Residence*

FRONT YARD *50'*

SIDE YARD *10'* SIDE YARD *25'*

REAR YARD *38' now 25' Left after addition*

NOTES *Adding 5' to present patio which is in place on footer & foundation*

IX. SITE OR PLOT PLAN - For Applicant Use

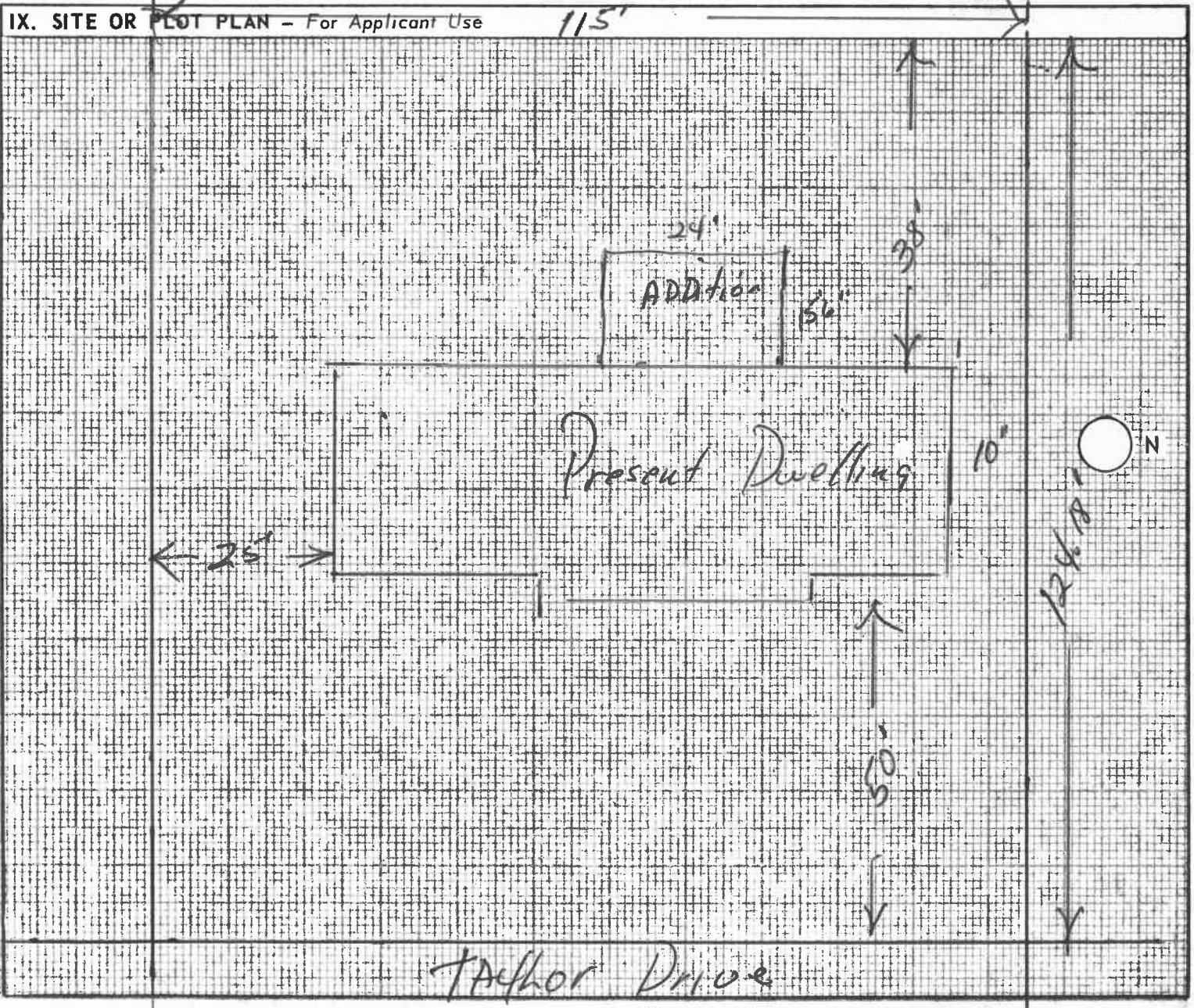

ROOFING FINISH

Asphalt over felt

ROOF PITCH

6-12

RAFTERS

2x6 or 2x8
at 16 o.c.

CEILING JOISTS

2x6 or 2x8 10
at 16" o.c.

WALL STUDS

2x4
at 16" o.c.

7'-6" clear floor
to ceiling height
(minimum)

EXTERIOR
WALL FINISH

Rough Sawn

INTERIOR
WALL FINISH

Rough Sawn Cedar

FLOOR FINISH

Cone

FOUNDATION
BOLT

1/2" x 10"
6'-0" o.c. max.

FLOOR JOISTS

size _____
at _____ o.c.

Top of foundation
to grade - 8" min.

FOUNDATION WALL

thickness 8"
depth 24"

FOOTER

width 16"
depth 8"

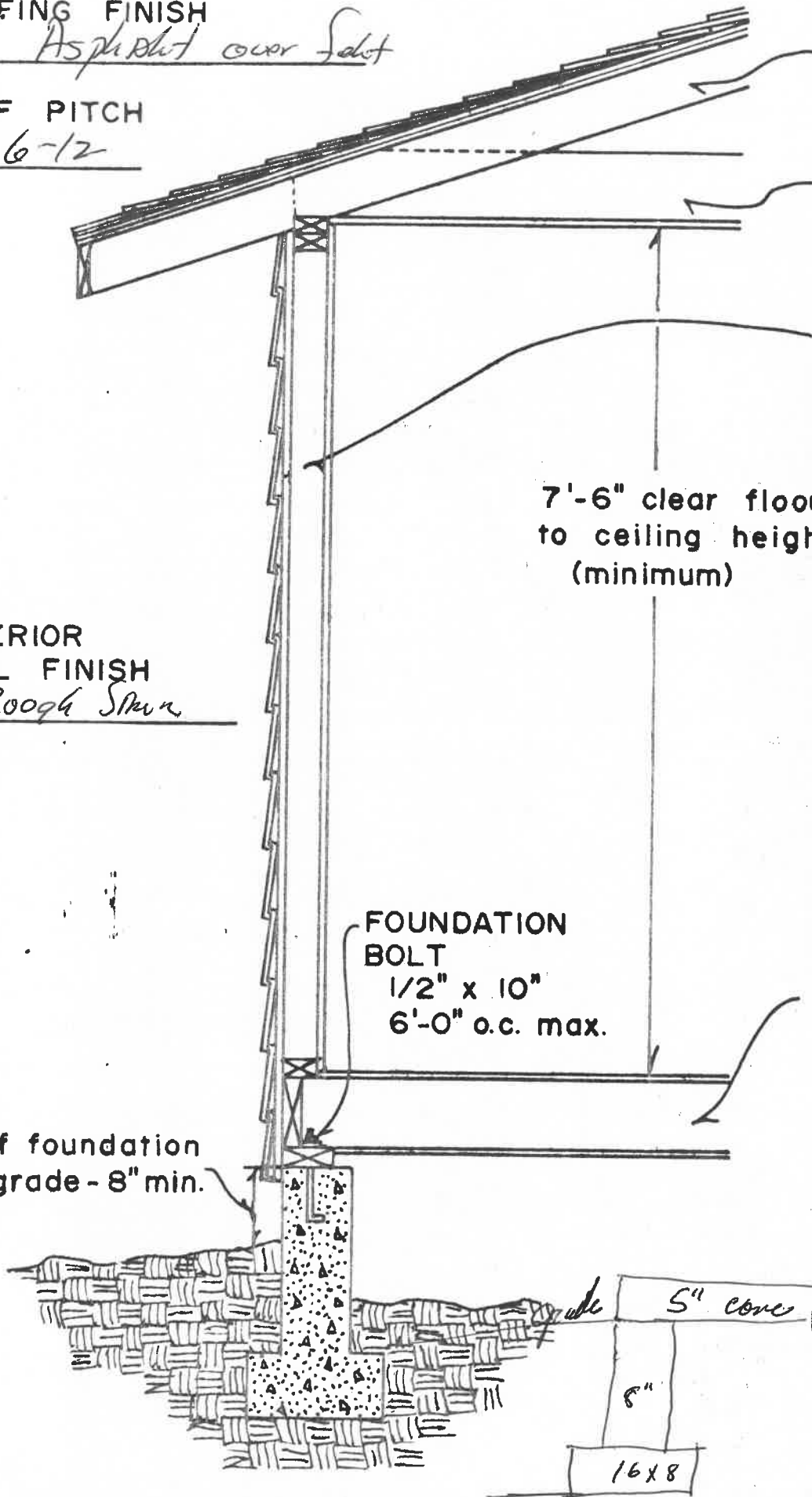

16x8

